

NEGUS RANGE

NEGUS LARYNGOSCOPES-

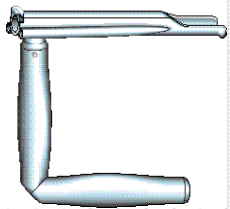

1 ADULT
CODE >> **SS884083**

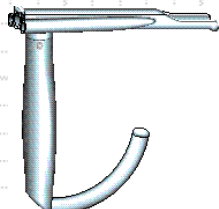

2 CHILD
CODE >> **SS884020**

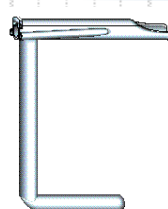

3 INFANT
CODE >> **SS884101**

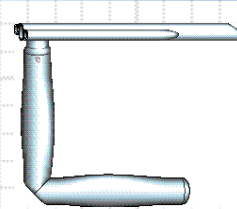

4 ADULT (AC)
CODE >> **SS884084**

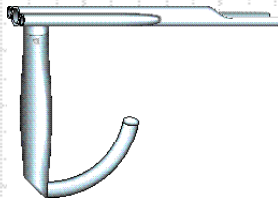

5 CHILD OESOPHAGAEAL SPECULUM
CODE >> **SS884022**

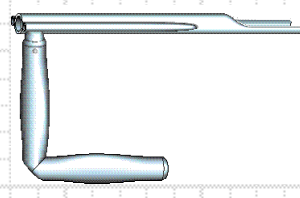

6 ADULT OESOPHAGAEAL SPECULUM
CODE >> **SS884021**

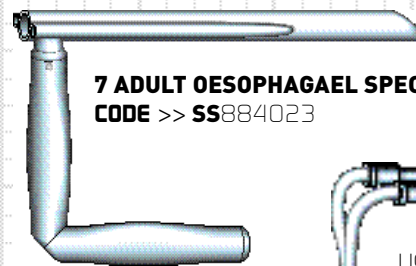

7 ADULT OESOPHAGAEAL SPECULUM
CODE >> **SS884023**

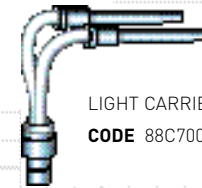

LIGHT CARRIER
CODE 88C700

PRODUCT	DESCRIPTION	LUMEN SIZE	EFFECTIVE LENGTH	FINISH	CODE
Negus Adult No.1	with sliding panel & twin side tubes to carry FLC 88C700	15mm x 15mm	135mm	polished metal (PM) stainless steel (SS)	PM884083 SS884083
Negus Child No.2	with sliding panel & twin side tubes to carry FLC 88C800	12mm x 12mm	99mm	polished metal (PM) stainless steel (SS)	PM884020 SS884020
Negus Infant No.3	with sliding panel & twin side tubes to carry FLC 88C900	10mm x 10mm	82mm	polished metal (PM) stainless steel (SS)	PM884101 SS884101
Negus AC No.4	with twin side tubes to carry FLC 88C700	10.5mm x 9mm	145mm	polished metal (PM) stainless steel (SS)	PM884084 SS884084
Negus Adult oesophagael speculum No.5	with twin side tubes to carry FLC 88C700	15mm x 15mm	222mm	polished metal (PM) stainless steel (SS)	PM884021 SS884021
Negus Child oesophagael speculum No.6	with long bevelled end with twin side tube to carry FLC 88C800	12mm x 12mm	153mm	polished metal (PM) stainless steel (SS)	PM884022 SS884022
Negus Adult oesophagael speculum No.7	with angled bevelled end with twin side to carry FLC 88C700	15mm x 15mm	207mm	polished metal (PM) stainless steel (SS)	PM884023 SS884023

NEGUS TRACHEASCOPE ADULT with twin side tube to carry FLC 88C800 11mm x 10mm Lumen, 218mm effective length polished metal (PM) PM884102 stainless steel (SS) PM884102
NEGUS TRACHEASCOPE CHILD end with twin side tubes to carry FLC 88C900 7mm x 6mm Lumen, 157mm effective length polished metal (PM) PM884103 stainless steel (SS) PM884103

*NB: AC- Anterior commissure

meditech
systems limited

Meditech Systems Limited
Unit 3 Richmond
Butt's Pond Industrial Estate
Sturminster Newton
Dorset DT10 1AZ



+44 (0) 1258 471 770
+44 (0) 1258 471 772

FOR ALL ORDERS CALL DIRECT **0700 - 4 - MEDITECH**